

Dump Trailer Side Extension Installation

Always wear protective clothing and eyewear when operating tools.
 Observe safe tool operation as specified in tool operating instructions.

PARTS

<u>Quantity</u>	<u>Description</u>
1	Left Hand Side Extension 8'
1	Left Hand Side Extension 6' or 4'
1	Right Hand Side Extension 8'
1	Right Hand Side Extension 6' or 4'
1	Front Extension
1	Left Hand Rear Extension
1	Right Hand Rear Extension
2	Joining Angle
12	3/8x1-1/4 HHCS
4	3/8x1-1/2 HHCS
8	3/8x2-1/2 HHCS
48	3/8 Flat Washer
24	3/8 Lock Washer
24	3/8 Hex Nut
3	Stud Cap - Plastic

INSTALLATION

Locate and identify all components supplied with the Dump Trailer Side Extension Kit. Hardware is packaged in a 7x10 plastic bag.

Note: Sheet Metal/ Expanded Metal Faces into the trailer on all pieces.

Locate the 8' left hand side extension; this extension has the end stake on the left when placed with the sheet metal or expanded metal opposite side (figure 1). Install this extension placing the end stake into the front 2x2 tube. The mount guide will fit over the top of the 3x2 bed tube. Locate the 6' (14' trailer) or the 4' (12' trailer) left side extension. Place the end stake into the rear 3x2 tube. Secure this extension to the 8' extension using (2) 3/8x1-1/4 HHCS, (4) 3/8 flat washers, (2) 3/8 lock washers and (2) 3/8 hex nuts. Clamp the joining angle to the top of the 8' and 6' (or 4') extensions (figure 2). Drill (4) 13/32" holes through the top tubes of the extensions.

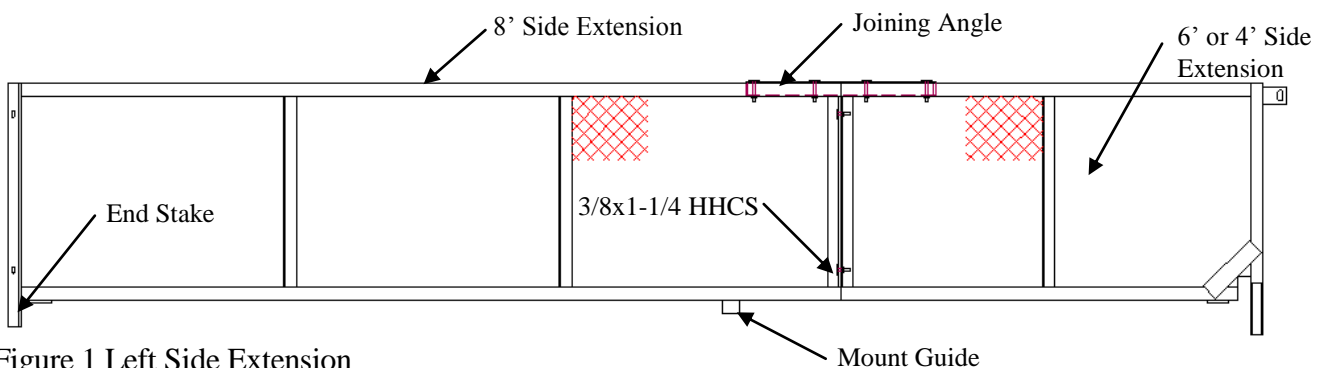

Figure 1 Left Side Extension

Manufacturer's Notice: All specifications are subject to change without notice and without incorporating them into prior units.

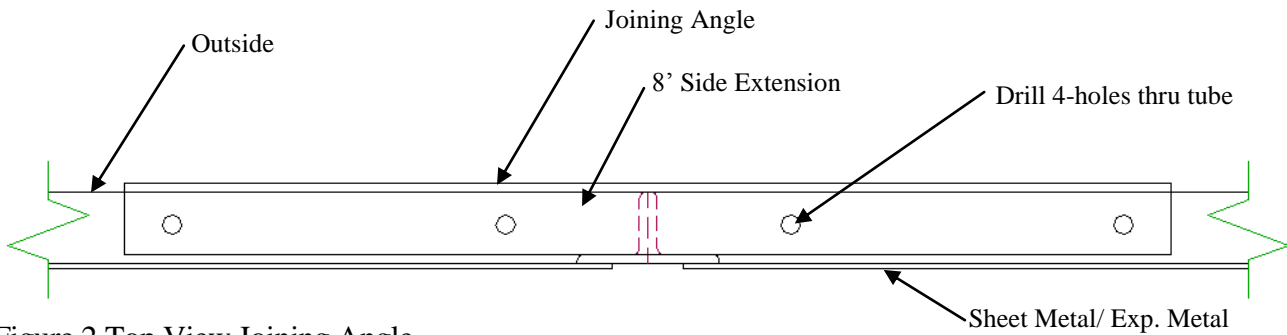

Figure 2 Top View Joining Angle

Secure the joining angle to the side extensions using (4) 3/8x2-1/2 HHCS, (8) 3/8 flat washers, (4) 3/8 lock washers and (4) 3/8 hex nuts. Install the right hand side extensions in the same manner.

Locate the front extension and set on front of the bed. Secure the front extension to the left and right side extensions using (4) 3/8x1-1/2 HHCS, (8) 3/8 flat washers, (4) 3/8 lock washers and (4) 3/8 hex nuts on each side.

Locate the left hand rear extension. Clamp extension onto left gate, offsetting the right hand side 1/8" from edge of gate. Verify that the extension will not interfere with the left side extension when metering. Drill (2) 13/32" vertical holes thru the extension and gate (Figure 3), and secure with (2) 3/8x1-1/4 HHCS, (4) 3/8 flat washers, (2) 3/8 lock washers and (2) 3/8 hex nuts. Locate the holes on the bottom of the extension and drill (2) 13/32" horizontal holes into the gate. Install (2) 3/8x1-1/4 HHCS, (4) 3/8 flat washers, (2) 3/8 lock washers and (2) 3/8 hex nuts from the inside of the trailer. Install the right hand rear extension in the same manner.



Figure 3 Rear Extensions